

FRENCH PAVILION



Elmia Nordic Rail

4-6 OCTOBER 2011
JÖNKÖPING, SWEDEN
HALL D02:50



MÖTESPLATS • KONFERENS • JÄRNVÄGSMÄSSA

UBIFRANCE
AND THE
FRENCH TRADE COMMISSIONS

www.ubifrance.fr

FRENCH PAVILION

Elmia Nordic Rail

4-6 OCTOBER 2011
Jönköping, SWEDEN

Elmia Nordic Rail, Jönköping is Scandinavia's largest rail trade show

The very first Elmia Nordic Rail fair was held in October 1995. The aim was to establish a platform for companies, organisations and people with a professional interest in the railway, primarily in the Nordic and Baltic countries, to discuss the future of major infrastructure investments. It met with an immediate response from the industry. It has since then taken place every other year, with participant numbers constantly rising. The first fair attracted just over 2,000 visitors. Since then numbers have more than doubled. The explanation behind the development lies in the fair's concept. Railway issues are often complex and require co-operation between politicians, the business community and industry experts. The fair attracts all these groups, and this has made it a natural part of the railway sector.

Organizer: Elmia in association with Nordic Infrastructure Managers (NIM), NJS - Forum for Nordic Railway Association and The Association of Swedish Train Operating Companies (ASTOC)

Product Category :

Future Transport
Fixed structures/local public transport
Freight traffic logistics
Infrastructure railway construction/technology
Railbound vehicles for public transit and freight transport
Service & services for vehicles
Streetbound vehicles for public transit and freight transport
Subassemblies and components
Transport management/communication/data processing

Statistics from 2009

No of visitors: 4 262
No of exhibitors: 222
No of countries: 15
Total exhibition area: 5 878

PLAN

Elmia Nordic Rail Future Transport

04- 06 okt 2011

NG NÖDUTGÅNG / EMERGENCY EXIT
BP BRANDPOST / FIREPOST
■ PELARE / PILLAR

Hall C

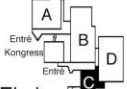

Skala: 1:300 0 10 20 Elmia

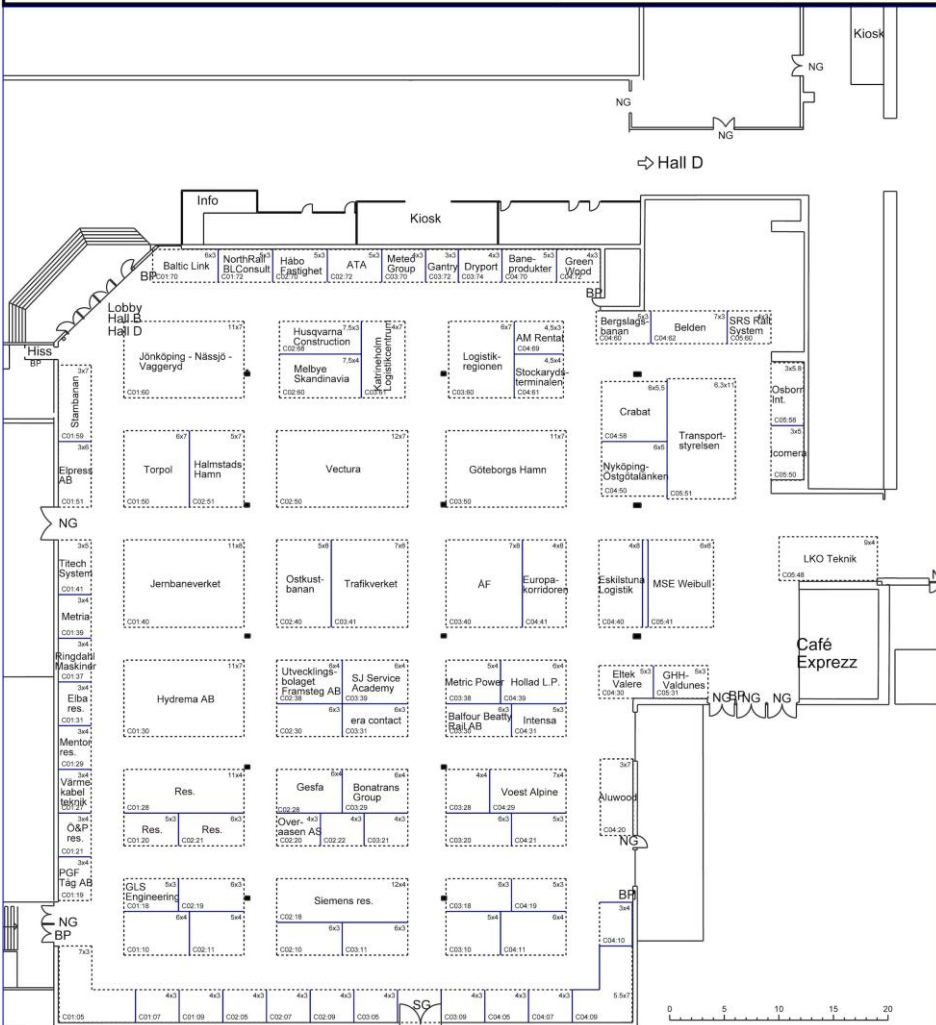

Hall C

INDEX

| | | | |
|------------------------------------|----------|------------------------------------|-----------|
| BORFLEX..... | 1 | MANQUILLET PARIZEL..... | 7 |
| CENTR'ALP | 2 | MEGGITT SENSING SYSTEMS ... | 8 |
| COLAS RAIL | 3 | ROV DEVELOPPEMENT..... | 9 |
| DEVISMES | 4 | SOPRANO..... | 10 |
| DUFLOT INDUSTRIE..... | 5 | SOURIAU SAS..... | 11 |
| I.D.M.S SA /ELNO GROUP..... | 6 | UBIFRANCE | 12 |

111, rue Saint Luc, B.P. 302
FR-59020 LILLE Cedex
Tél. : +33 (0)3 20 21 99 50
www.borflex.com

CONTACT

Thierry GERME, Export manager
Email : t.germe@borflex.fr



Borflex studies and supplies rubber, polyurethane and TPE products and systems for equipment used in the public transportation. Our core business is the manufacture of door seals and window gaskets in fire resistant rubber.

Our other products are assembled on bogies, floors, interiors, seats, roofs and pantographs. Since 1949 Borflex has managed and improved all rubber processes including :

extrusion, welding, hose making, moulding, injection moulding and polyurethane casting.

On our own laboratories and mixing units, we have developed a wide range of rubber products that are compliant with major fire resistance standards in European countries, in the USA, and Asia (NFF, DIN, BS, ASTM, ...) and standard EN45 545 is expected soon.

Our vision is to be your first partner in sealing technology and other application requiring rubber or polyurethane products as well.

BORFLEX's Key Figures:

- Turnover: 18 000 k€ (export 15%)
- 200 employees
- 8 different factories



Site internet :
borflex.fr
sealing-technology.eu

Transport Sealing Technology Solutions d'étanchéité dans les transports

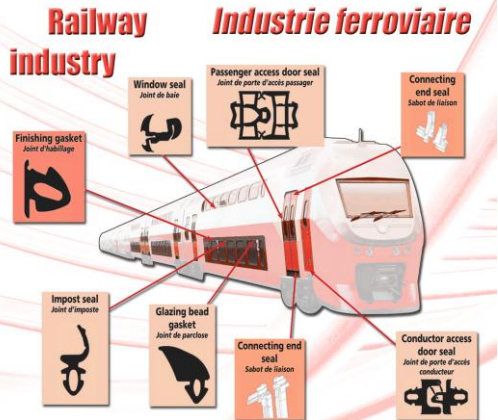

111, rue Saint Luc - B.P. 302 - 59020 Lille Cedex (France)
Tél. +33 (0)3 20 21 99 50 - Fax. +33 (0)3 20 55 37 23 - export@borflex.fr

21 rue Marcel Pagnol
FR-69694 VENISSIEUX
Tél. : +33 (0)4 72 78 35 10
www.centralp.com

CONTACT

André BLANCHARD,
Embedded field manager
Email : ablanchard@centralp.fr

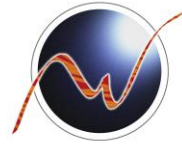

C E N T R A L P

CENTRALP, leadership and innovation !

European leader in embedded intelligent systems, CENTRALP designs and manufactures innovative solutions in railway applications, integrating associated constraints with specific environments : vibrations and shocks, external temperature range, humidity and dust, EMC, safety...

Based on its long time experience, CENTRALP ensures the perennity of its embedded boards and MMIs. CENTRALP manages all the phases of a product development cycle: functional needs, prototypes, technical specifications, manufacturing, hardware design and software development, quality management, mechanical integration, availability, perennity, warranty, qualification in railway norms, project leading.

Our development skills are based on 3 R&D departments: hardware, software, mechanical integration, including expertise of hostile environments and norms and capacity for technical assistance and long term partnership.

Our production units are dedicated to electronic boards assembly and equipment integration lines.

In a dynamic of innovation and performance, CENTRALP's ambition is to impose itself like a major player of the Embedded Field, offering the insurance of a long life solution adapted to the specific requirements and constraints of our customers.

44 rue Jean Mermoz
FR-78600 MAISONS LAFFITTE
Tél.: +33 (0)1 34 93 83 00
www.colasrail.com

CONTACT FRANCE

Agnès PIOGER, Communication Manager
Email : pioger@colasrail.com

Dacre House, Dacre Street
UK- SW1H 0DJ LONDON
Tel: +44 (0) 207 593 5357,
www.colasrail.co.uk

CONTACT UK

Julian DUNN,
Development Director Europe
Email : julian.dunn@colasrail.co.uk
Tel : +44 (0) 7739 988 319



The Colas Group is the world leader in road construction. Its railway division is one of Europe's leading providers of rail infrastructure services.

Colas Rail combines the engineering skills of all our specialist businesses to provide total solutions in all aspects of railway infrastructure, from high speed rail systems to light and urban rail. We are award-winning specialists having designed and constructed all forms of railway across Europe. This success has been achieved through our greatest asset, our people. With this unity of purpose, we will play our part in providing 21st century railway systems throughout the world.

- **Expertise Overview**
 - Trackwork
 - Electrification
 - Power and Plant
 - Civils & Structures
 - Signalling & Telecom's
 - Multi-disciplinary Projects and Systems Integration
- **Engineering Capabilities**
 - Multi-disciplinary design & build engineering solutions
- **Project Capabilities**
 - Multi disciplinary systems integration
 - Project management/complex logistics
 - Permanent way
 - Signalling & Telecommunications
 - AC & DC electrification
 - Civil engineering
 - Infrastructure Maintenance
- **Track Renewals Capabilities**
 - High Output Track Renewals
 - Conventional Plain Line
 - S&C Track Renewals
- **Rail Services Capabilities**
 - The largest, most advanced fleet of modern on track plant
 - International freight operator

Z.A du Vimeu Industriel - B.P 20027
FR- 80210 FEUQUIERES-EN-VIMEU
Tél. : +33 (0)3 22 61 2 6 12
www.devismes.fr

CONTACT

Bertrand DEVISMES, Sales Manager
Email : devismes@devismes.fr



DEVISMES has held an important position over 50 years in the international rail market. **150 collaborators** are currently working for the company on 5 different locations (3 in France and 2 in Tunisia).

DEVISMES is a specialist in:

- - Fine sheet metal work
- - Laser cutting and Stamping
- - Locking systems

The company has also acquired specific expertise in the field of locking, shutting and accessibility products and has worked on relevant projects such as: TGV, TRE 2NG, AGC.

For many years, DEVISMES has been trusted by **SNCF, ALSTOM, BOMBARDIER** as well as many equipment manufacturers in the railway sector. DEVISMES engineering office works closely with its customers to develop complete systems which are ready to be installed in rail carriages.

DEVISMES will showcase their **innovative Locking Systems (AXE System)** designed for the railway sector. The AXE'S Tactile Lock has been developed in partnership with SNCF in order to facilitate access to train bathrooms for disabled people.

Moreover, DEVISMES has introduced **a visual and a tactile effect which inform in as simple direct and efficient way the availability of the bathroom.** DEVISMES manufactures their products in accordance with **European norms** regarding accessibility.

Zone Industrielle, CD 115 A – BP 40069
F-59542 CAUDRY Cedex
Tél : +33 (0)3 27 76 09 09
www.duflot.com

CONTACT

Jacques FOURMEUX, Export Manager
Email : jfourmeux@duflot.com



DUFLOT INDUSTRIE is one of the world's leading suppliers of fireblocking layers and vandal-proof solutions for railway seating. These materials are marketed under the registered trade marks ISOMEX[®] and DUFELT[®].

ISOMEX[®] and DUFELT[®] meet all international railway specifications and the highest performance standard required in terms of fire resistance, smoke release and toxicity.

Made from the best materials available in terms of performance, they have proven their total effectiveness over a long service life, which is the best guarantee that safety requirements will be observed throughout the life of the seat. ISOMEX[®] and DUFELT[®] offer highly reliable cost-effective solutions for the safety of railway passengers. ISOMEX[®] and DUFELT[®] are registered trade marks of DUFLOT INDUSTRIE.



17 rue du Vertuquet, Les Peupliers
F-59960 NEUVILLE EN FERRAIN
Tél. : +33 (0)3 20 69 99 82

www.elno.fr
CONTACTS

Cyril BORDES, Sales manager Europe
Email : c.bordes@elno.fr
Bernard VERDY, Export sales manager
Email : b.verdy.idms@nordnet.fr



The ELNO group has been designing turnkey solutions for the rail industry since 1950. IDMS/ELNO has project-oriented resources to work with railway operators, railcar manufacturers and integrators.

On-board Passenger Information Systems

Analogue and Ethernet-based architecture to bring clean and secure visual & voice announcements, intercom & alarms, GPS, rear-viewing & video surveillance, monitoring, cameras, and entertainment for high-speed, regional, tramway and metro applications

Stationary Public Address & Automatic Announcement System

Fully integrated and combined hardware and software allowing both the process and the automatic broadcasting of voice and visual messages relating to the trains circulations and railway traffic disruption in main stations but also halt points of the railway lines. Automatic broadcasting of voice messages is fully digital and data transmission is supported by a TCP/IP network. We are the designer & manufacturer of our own Public Address System.



26, rue de l'Industrie
FR- 08800 LES HAUTES RIVIERES
Tél. : +33 (0)3 24 53 67 97
www.manquillet-parizel.fr

CONTACT

Jean-Hugues BOURGEOIS, Director
Email : jh.bourgeois@manquillet-parizel.fr



MPS is producing **forged parts** for railway industry. MPS has production plant with 70 employees in France and a turnover of 11 M€, 100% dedicated to railway business.

MPS' processes are: Forging, machining, heat treatment, welding, painting, mounting. MPS is doing reverse engineering for spare parts.

MPS is certified for ISO 9001, ISO 14001, ISO18001, EN 15085-2 (Welding CL1). Our main customers are SNCF, DB, ALSTOM, FAIVELEY, VOSSLOH COGIFER, ETS, AAE, SNCB, BOMBARDIER, KNORR BREMSE, RATP.

We have more than 25000 forging dies for parts for Freight Waggon, Turnouts, Passenger boggies, Shaku couplers and parts for locomotives and TGV. We are currently producing 30000 disc brakes calipers for SNCF for French TGV.

Brake disc calipers for TGV (SNCF)



Parc d'affaires international
FR- 74166 ARCHAMPS
Tél. : +33 (0)4 50 95 43 70
www.sensorex.fr
www.meggittsensingsystems.com

CONTACT

Bernard TAPIE
Email : bernard.tapie@fr.meggitt.com

Sensorex

MSS (Sensorex) manufactures acceleration, tilt, and displacement sensors for severe environment, where only the highest reliability is acceptable. The outstanding performance of these sensors makes them ideal for use in ATC and ERTMS, as well as for railway maintenance and monitoring.

- **Accelerometer:** it enables the position of the train to be calculated for ATO and ATP, and the braking profile to be directly monitored for passenger comfort and real-time LMA calculation. Our servo-accelerometers are closed loop instrumentation transducers, and are qualified to EN50155
- **Inclinometer & LVDT:** modern track laying and maintenance equipment require permanent and reliable tilt measurement. This is achieved thanks to our high-precision inclinometers and LVDT. On-board track laying machines, inclinometers are used to measure slope, tilt and rail profile, whilst LVDT check rail surface integrity and relative position.
- **Inertial Measurement Unit:** it integrates latest MEMS sensors generation with no moving parts ensuring a high performance in severe environments. It is used to measure rate and acceleration according to 3 axes. Thanks to the MSS (Sensorex) technology, our IMU reaches a very high accuracy. Rugged & compact, this IMU is ready to be integrated in a wide range of applications such as rail vehicle behaviour studies, control and stabilisation ...
- **Signal conditioners & hybrids:** a large part of our activity is the design and manufacture of thick film hybrid circuits. This technology allows miniaturization of electronic functions with improved reliability. These are used for signal conditioning of LVDT and strain gage sensors, and also as OEM components. We also supply standard DIN rail or Europe Card signal conditioners.



168 av. du Serpolet, ZI Athelia II
FR- 13600 LA CIOTAT
Tél. : +33 (0)4 42 08 81 19
www.rovdeveloppement.com

CONTACT

Edmond BRIAND, Chief Executive Officer
Email : contact@rovdeveloppement.com



For over 20 years we manufacture robots, cameras and telemanipulators for large groups and leaders in areas of railways, environment, industry and offshore.

Our engineers and technicians have an international experience in all these fields that confers them a great flexibility. All the stages of design and production are home-made and this, in order to obtain equipments ever more efficient and resistant to physical stresses encountered during their use.

Our strength :

- Centralisation of research and development activities in all divisions.
- Application of important IT and development software
- Exhaustive research and development expertise in fields of electronics, optics and video technologies, mechanics and hydraulics

Presented for the 1st time in Sweden, **CAMEROV® VISIOCAT** was the **winner of innovation for sustainable development awards** (infrastructure) during the last **SIFER's** exhibition in Lille.

CAMEROV® VISIOCAT is a small camera on an isolating telescopic pole to inspect catenaries and electric traction installations 1500 and 25000 V

- Other equipments developed for railways .
- **CAMEROV® HDD** : Automatic system for measurements without contact for **Height, Stagger** of contact wires and track **Superelevation**
- **CAMEROV® TOR 200** : Robot for observation of structures under tracks



ROV DÉVELOPPEMENT

A NEW LIGHT ON EXTREME ENVIRONMENTS

40, rue Concordet
FR- 38090 VAULX MILIEU
Tél. : +33 (0)4 74 82 27 27
www.soprano.fr

CONTACT

Philippe FRANCOIS, Commercial manager
Email : pfrancois@soprano.fr



SOPRANO Industry designs, manufactures and sells systems to ensure comfort and transport quality for people in harsh environments such as rail, aerospace and military. Its services cover the supply system of air conditioners, controllers, power converters and ventilation systems.

SOPRANO is specialized in the design and implementation of systems such as:

- Air conditioning, heat pumps, cogeneration, heating, ventilation and air distribution
- Electronic control system (PLC for control of auxiliary control air quality as CO2)
- Energy Conversion (Converters / Inverters for Auxiliaries up to 100 kVA)
- Energy measurement systems with location and transmission to central servers throughout the embedded measurement chain

Product Details:

- Air Conditioning and Air distribution: HVAC Units for driver's cabin and passenger's saloon
- Air conditioning units with variable frequency converter for driving cab and passenger compartment, sets of air distribution for new built and refurbishment
- Embedded Electronics: Equipment for monitoring and control of air
- Soprano develops and offers a range electronic controllers and PLC's particularly suited to harsh environments of railway rolling stock
- Energy Conversion: Energy Converters for auxiliaries, battery chargers.

Soprano develops and offers wide range power converters up to 100 kVA based on a modular concept. Our solutions are designed to improve energy saving.

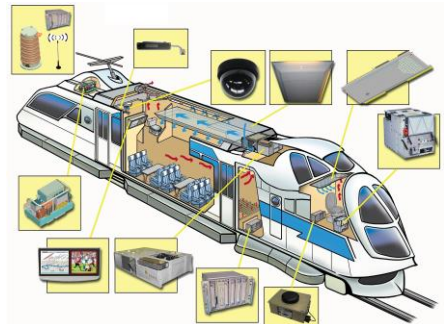

SOPRANO is ISO 9000 V2008 and

IRIS certified



9, rue de la porte de Buc
FR- 78000 VERSAILLES
Tél. : +33 (0)1 30 84 77 99
www.railway-connectors.com

CONTACT

François-Xavier MARCHAIS,
Industry Business Unit Director
Email : fmarchais@souriau.com



SOURIAU is a recognized worldwide market leader in the design and manufacture of connectors and interconnect systems for severe environments. SOURIAU's major markets are:

- Heavy Industry : Railway & Mass Transit, Nuclear, Oil & Gas
- Industrial Equipment
- Aerospace
- Defense / Space

SOURIAU has a worldwide presence, with R & D centers and production sites in Europe, USA, Japan and India.

For more than 50 years, SOURIAU has become a trusted name by major railway equipment manufacturers, their subcontractors, and signalling & infrastructure companies.

SOURIAU connectors are designed to integrate new functions such as Ethernet network, mixed signal-power, lightweight composite materials. They comply with railway standards and environmental requirements.

SOURIAU's offer is the best compromise between technology, safety, reliability and cost.



77 Boulevard Saint-Jacques,
FR-75998 PARIS CEDEX 14
+33 (0)1 40 73 30 00
www.ubifrance.com/se

 **CONTACT SWEDEN**

Aurélie Devidal, Trade officer
Tel.: +46 (0)8 545 89 159
Email: aurelie.devidal@ubifrance.fr



UBIFRANCE, the French agency for international business development, comes under the aegis of France’s Ministry for the Economy, Finance & Industry. UBIFRANCE lies at the heart of France’s public-sector exportsupport framework.

With 65 Trade Commissions in 46 countries, UBIFRANCE offers a comprehensive range of products and services aimed at accompanying French-based companies in their development on export markets :

- Knowledge-based products and services, from business information to consultancy and monitoring services, in order to help companies elaborate a strategy for international expansion
- Promotional operations in order to foster partnerships with companies outside France.

Your contacts in the Nordic countries:

 **UBIFRANCE Sweden**
Aurélie DEVIDAL, Trade Officer
Storgatan 11,
SE-114 44 Stockholm
Tel : +46 (0)8 545 89 150
E-mail : aurelie.devidal@ubifrance.fr

 **UBIFRANCE Denmark**
Simon SOUSTELLE, Trade officer
Hammerensgade 6,
DK-1267 COPENHAGUE K,
Tel : +45 (0)33 37 61 91
E-mail : simon.soustelle@ubifrance.fr

 **UBIFRANCE Norway**
Martin HENNUM, Head of Industry
Holtegaten 29,
NO-00355 OSLO
Tel. + 47 (0)23 33 33 68
E-mail: martin.hennum@ubifrance.fr.

 **UBIFRANCE Finland**
Vincent JOLY, Head of Industry
Yrjönkatu 36
FI-00100 HELSINKI
Tel.: +358 (0)9 680 36 338
E-mail : vincent.joly@ubifrance.fr



www.ubifrance.fr

ELMIA NORDIC RAIL 2011

This French Pavilion is organized by :

UBIFRANCE Sweden

The French agency for International Business Development

French Embassy in Sweden

Storgatan 11,

SE - 114 44 Stockholm

Tel: +46 (0)8 545 89 150

Fax: +46 (0)8 662 38 80

www.ubifrance.com/se

Contact: Aurélie DEVIDAL

Trade Officer

Tel: +46 (0)8 545 89 159

Email: aurelie.devidal@ubifrance.fr

WEBSITE

www.ubifrance.com